

DW 14 AND DW 16 SERIES FRAMES

SLIP ON KD DRYWALL FRAME WITH COMPRESSION ANCHOR

Specifications

1. Frames shall be manufactured from 14 or 16 gage steel per ASTM A1008, A568, & A569 or A60 Galvannealed per ASTM A924 & A653 in sizes up to 8'-0" x 9'-0"
2. Frames shall be knocked down for field assembly. Mitters shall have a precision hairline joint when assembled.
3. Each jamb shall be provided with a permanently installed Compression anchor. The Compression (Pressure Fit) anchor mechanism shall have no loose retaining rings, washers or clips.
4. All frames shall be provided with weld-in sill anchors pre-drilled for attachment of the base of the jambs to the floor runner.

OPTION: Frames shall be provided with pierced holes at the base of the jambs for screw attachment directly to the floor runner.
5. Heads shall be reinforced for surface applied closures, holders or brackets when required.
6. Dual purpose hinge reinforcements shall be 3/16" thick for 1-3/4" door, comes with galvanneal back-up filler plate for standard weight hinges. Conversion from standard weight to heavy weight hinges is done by removing the filler plate.
7. The standard strike preparation for ASA 4-7/8" strike shall be one piece strike reinforcement in combination with plaster guard and security angle to prevent depression of jamb and release of the latch bolt.
8. All frames shall be prepared to receive G.J. 64 type silencers: three for single frame and two for pair frame.
9. An angle shall be welded inside the base of each jamb to allow for job site vertical shimming.
10. Heads of pair frames over 4'-0" wide shall be prepared with a universal "knock-out" to accept flush bolt on inactive door leaf.

OPTION: Heads of pair frames shall be prepared to receive mortised flush bolt strike as required.
11. Frames shall be prime painted by Pioneer's exclusive painting process, consisting of a wash, phosphate treatment, Electrostatic spray painting and oven baking per ANSI A250.10.
12. Frames shall be furnished with 20-90 minutes UL or WHI Listing Mark (Label) in compliance with UL10B and UL10C. Smoke Rating requires Listed Gasket. Frames must be installed per NFPA 80 and in accordance with Pioneer's Installation Instructions.
13. 16 and 14 Gage Frames complies with ANSI A 250.8 (SDI-100) as LEVEL 2 and LEVEL 3 respectively.
14. Hardware preparations and reinforcements comply with ANSI A250.6. Locations are in accordance with ANSI/BHMA A156.115.

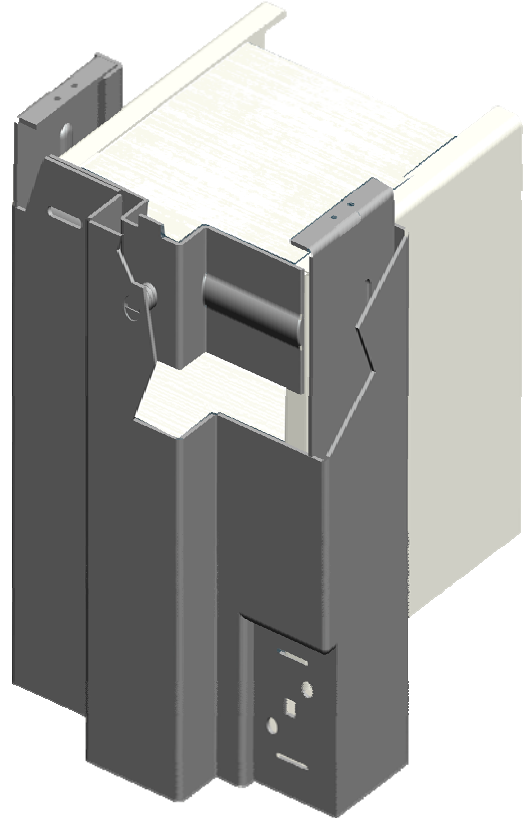

DW 14 and DW 16 SERIES FRAMES

SLIP ON KD DRYWALL FRAME WITH COMPRESSION ANCHOR

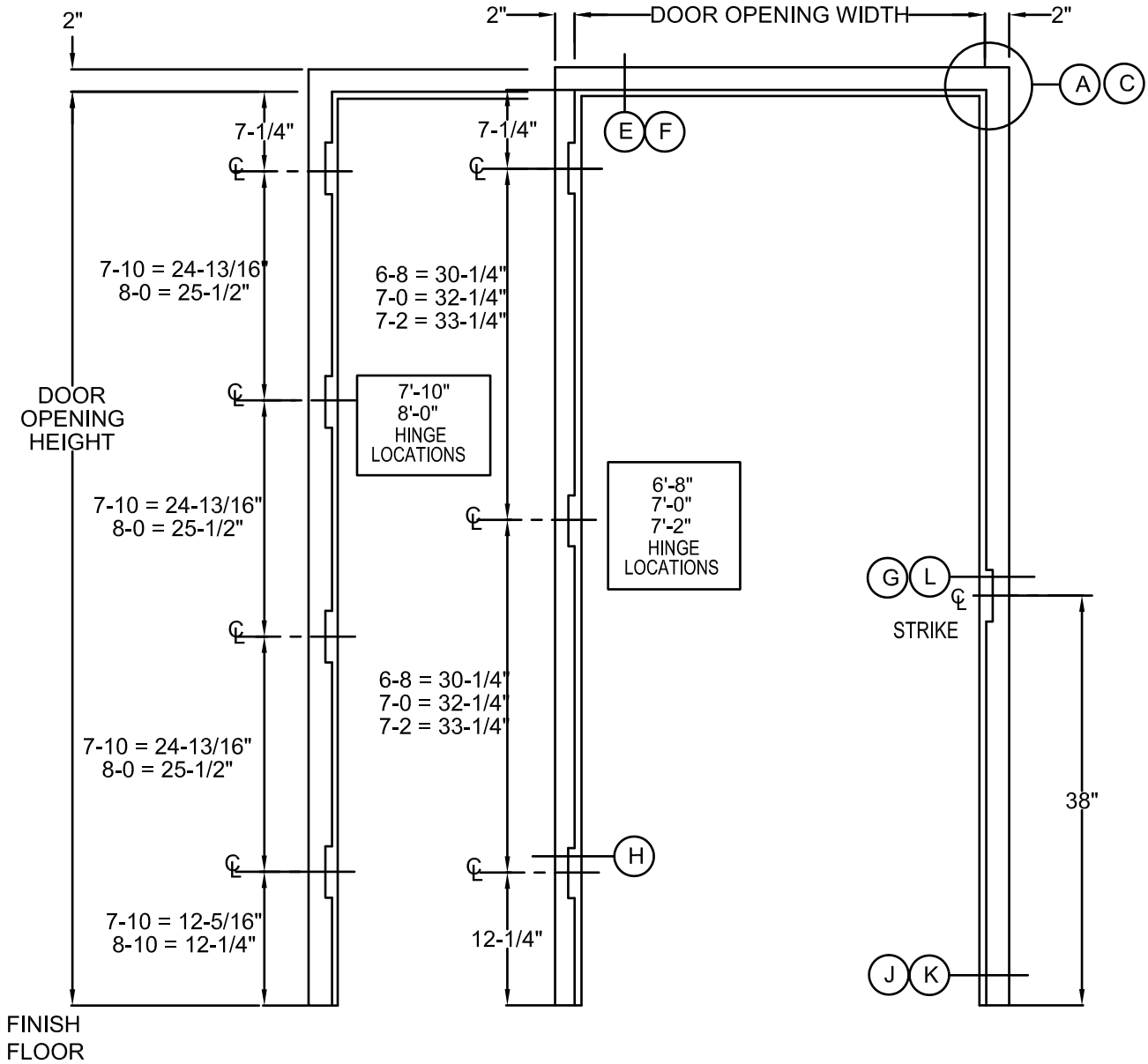

ELEVATION

DW 14 AND DW 16 SERIES FRAMES

SLIP ON KD DRYWALL FRAME WITH COMPRESSION ANCHOR

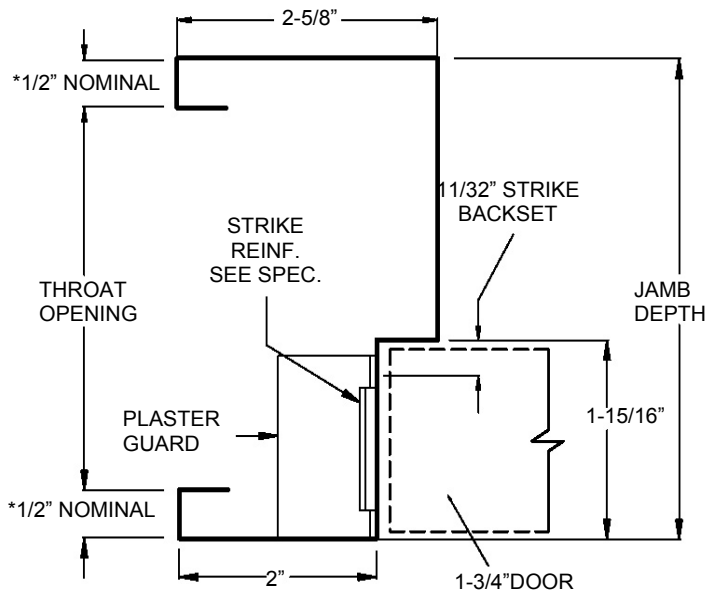
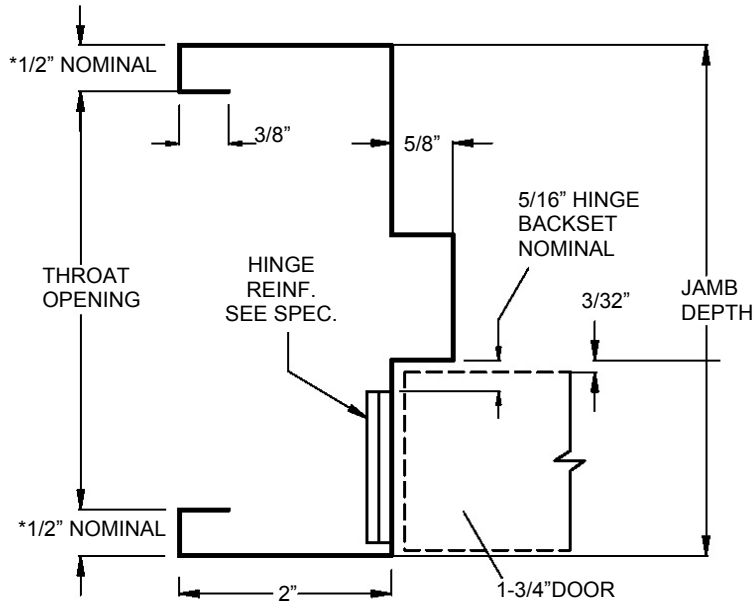

DW 14 AND DW 16 SERIES FRAMES

SLIP ON KD DRYWALL FRAME WITH COMPRESSION ANCHOR

STANDARD SIZES *

DOOR OPENING HEIGHT	DOOR OPENING WIDTH SINGLE	PAIR	JAMB DEPTH
	2'-0"	4'-0"	
	2'-4"	4'-8"	
	2'-6"	5'-0"	
6'-8"	2'-8"	5'-4"	
7'-0"	2'-10"	5'-8"	
7'-2"	3'-0"	6'-0"	
7'-10"	3'-4"	6'-8"	
8'-0"	3'-6"	7'-0"	
	3'-8"	7'-4"	
	3'-10"	7'-8"	
	4'-0"	8'-0"	

*For other sizes consult factory.

NOTES

STANDARD HINGE PREPARATION:

1 ½ pair of 4 ½ x 4 ½ standard weight template hinges for 6'-8", 7'-0" * 7'-2" height. 2 pair for 7'-10" & 8'-0" height.

STANDARD STRIKE PREPARATION:

ASA 4-7/8" furnished as standard.

FIRE RATED LABEL:

All 16 Ga. Frames available with Underwriters Laboratories label unless specifically prohibited by .

STANDARD FINISH:

All frames are furnished with a baked prime finish.

MANUFACTURING TOLERANCES

Door Opening width
nominal opening + 1/16", -0"

Door opening height
nominal opening ± 1/16"

Jamb depth ± 1/16"

Throat
(between returns) ± 1/16"

Hardware cutouts

Template dimension + 1/64", -0"

Hardware Prep location

Height ± 1/64"

Backset ± 1/64"

Depth + 1/32", - 0"

DW 14 AND DW 16 SERIES FRAMES

SLIP ON KD DRYWALL ÜÇET ÖY ÜPÁ COMPRESSION ANCHOR

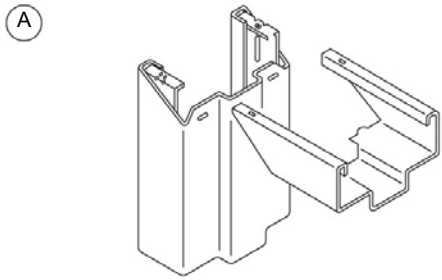

CORNER SECTION

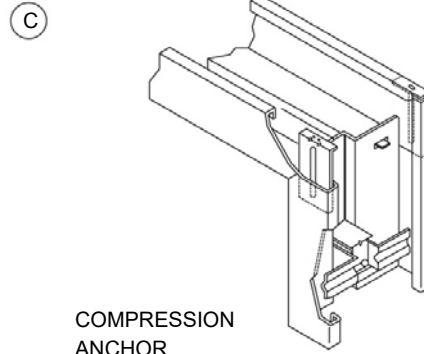

COMPRESSION ANCHOR

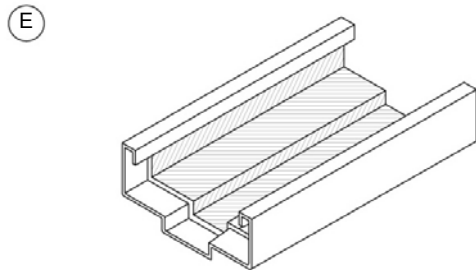

CLOSER SLEEVE

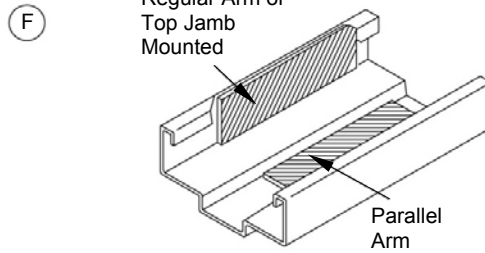

CLOSER REINF. (WELD-IN)
 (AVAILABLE FOR VARIOUS TRIM AND STEP APPLIED DEVICES)

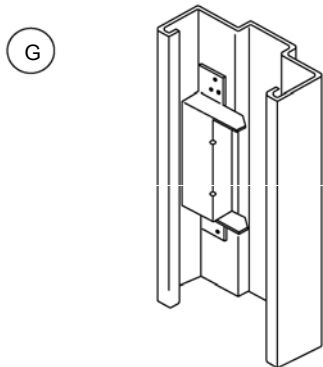

ANSI A 115-1 STANDARD 1-PIECE STRIKE REINFORCEMENT WITH SECURITY ANGLE

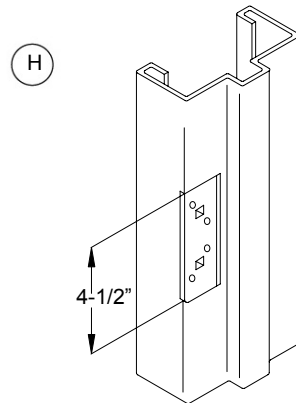

DUAL PURPOSE MORTISE HINGE PREPARATION WITH BACK-UP FILLER PLATE

DW 14 AND DW 16 SERIES FRAMES

SLIP ON KD DRYWALL ÜÇET ÖÁ QPÁ COMPRESSION ANCHOR

J

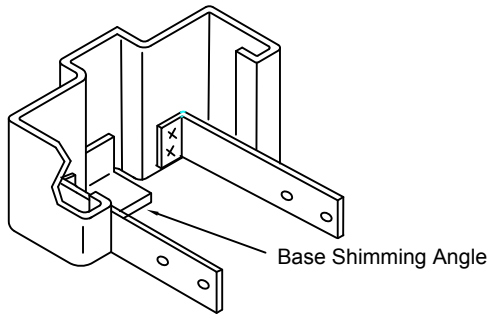

WELD ON SILL ANCHOR STANDARD

K

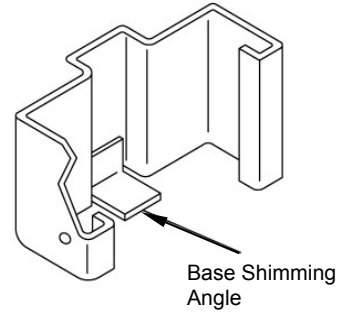

SCREW APPLIED SILL ANCHOR (Optional)

NOTE:

In order to provide our customers with the finest products, manufactured in the most up to date manner, Pioneer Industries reserves the right to make design or specific construction changes without notice.

Pioneer Industries will not be responsible for errors incurred by other parties through the use of this data sheet without written confirmation from Pioneer. Other trades should contact Pioneer for exact hardware locations.